

Risk Assessment information for all activities by individuals and groups at Elysian

Address:

Elysian Animal Assisted Therapy & Learning CIC
Janche Stables,
Andlers Ash Road,
Liss
Hampshire
GU33 7LU

What3words: drag/gazes/quest

Contact Details:

Office mobile 07588 905591

In the event of an emergency:

Call 999 & Use site WhatsApp chat group.

Nearest hospital:

- Petersfield Community hospital (walk in centre): Swan St, Petersfield GU32 3LB
- Queen Alexandra Hospital: Cosham, Portsmouth PO6 3LY
- Royal Surrey Hospital: Egerton Rd, Guildford GU2 7XX

First Aid kits are provided in the office, first aid room, arena, kitchen and grey cabin.

The Site First Aiders are:

Karen Lee, Jo Mumford, Kay Longbottom, Graham Hockley

The Site Fire Warden are:

Graham Hockley, Kay Longbottom, Jo Mumford and Tamsin Murrell



MAP OF SITE

SCALE 1:1500

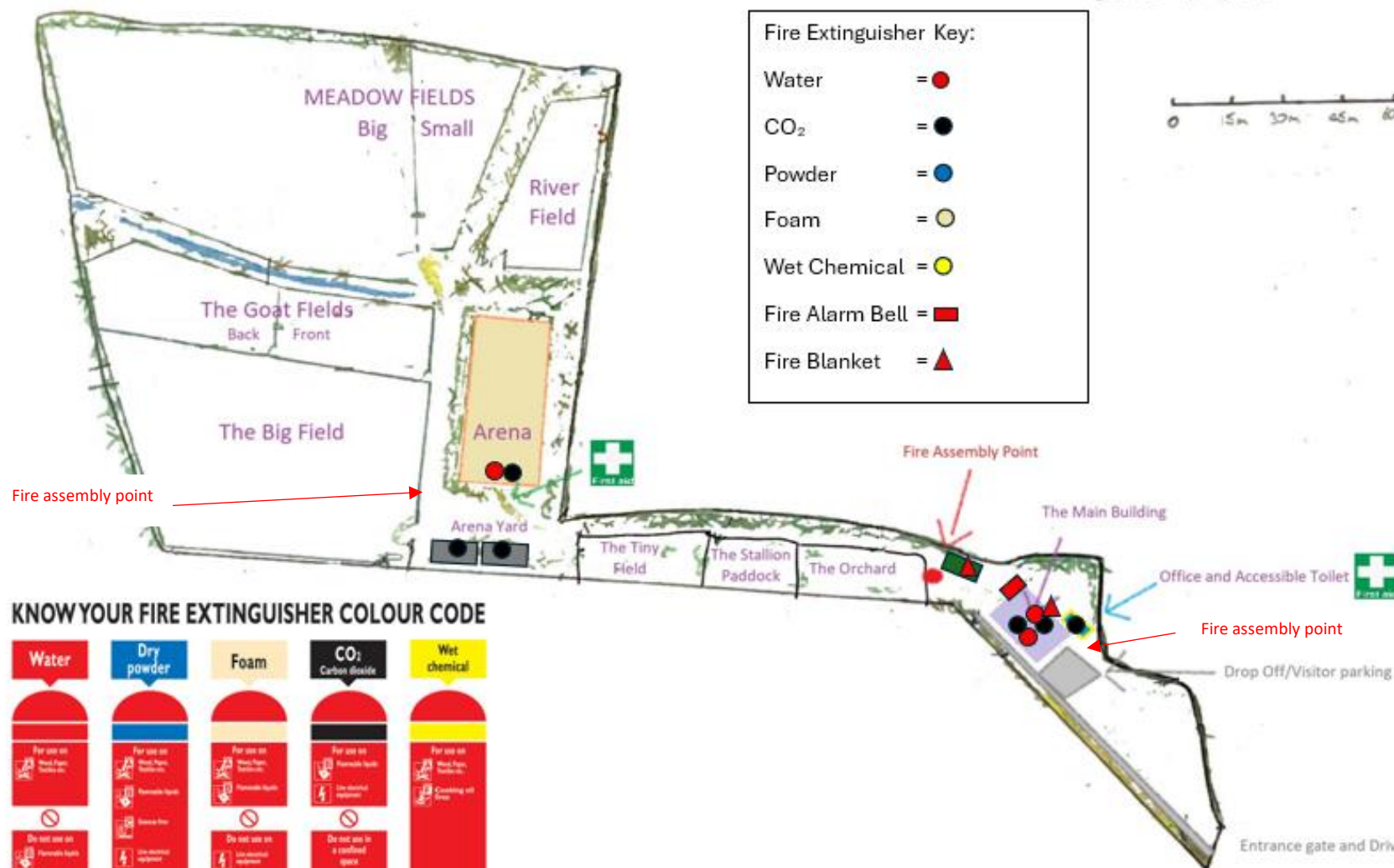

Fire Extinguisher Key:

- Water = ●
- CO₂ = ●
- Powder = ●
- Foam = ●
- Wet Chemical = ●
- Fire Alarm Bell = ■
- Fire Blanket = ▲

KNOW YOUR FIRE EXTINGUISHER COLOUR CODE



Additional Field

Fire assembly point



ACTIVITY/LOCATION	HAZARDS	THOSE AT RISK	RISK LEVEL	ACTION - RISK REDUCTION MEASURES	ACTIVITY/LOCATION
Contact with animals/farm environment	Infection and disease from contact with animals	All, especially children and pregnant women	HIGH	<p>Children and adults must wash and dry hands using soap and water and paper towels after contact with animals, before eating and when leaving the farm. School staff/carers must supervise children's handwashing. Open wounds should be covered with a waterproof dressing. Handwashing facilities available on the farm.</p> <p>Animal faeces regularly swept off paths and animals kept in enclosures</p> <p>Pregnant women should not come into contact with sheep at lambing time.</p> <p>For more information about specific risks see:</p> <p>http://www.face-online.org.uk/face-news/preventing-or-controlling-ill-health-from-animal-contact-at-visitor-attractions</p> <p>http://www.cdc.gov/parasites/toxoplasmosis/</p> <p>http://www.hse.gov.uk/campaigns/farmsafe/ecoli.htm</p>	LOW
Contact with animals/farm environment	Injury from biting, kicking, trampling	All	MED	<p>Animals kept in fenced paddocks or enclosures and are handled with the support of staff. Children & Young People and all Visitors are alerted if the animals will be out of their areas. Visitors are not permitted to feed animals except on guided sessions, in sessions or tours with staff. staff to make individuals and groups aware of safe behaviour around the farm. Where a person is upset or angry, staff need to consider the potential impact on the animal and the possible increased risk of unwanted behaviour from the animal, this may include ensuring the animal is contained away from the child or young person.</p>	LOW

Contact with animals/farm environment	Allergic reaction to animal or bedding	People with asthma and other allergies	LOW	Staff/carers are responsible for supporting individuals within their arranged groups or sessions, and ensuring they are aware of the children and young people's completed Health and Safety information as to not expose anyone to allergens or reduce exposure accordingly. Staff need to ensure any visitors or group discuss with staff any known allergies prior to the visit, or on arrival before undertaking any activities. Entry into more enclosed areas such as hay barn and animal enclosures is only with permission and under the instruction of staff and may not be suitable for children with allergies such as asthma.	LOW
Compost/Manure Heaps	Infections	All	MED	No contact with manure heaps or compost heaps (except for arranged activities under the direction of staff, who will be able to guide on appropriate safety measures.	LOW
Access to Farm	Road, group members leaving the farm	Children	LOW	<p>Visitors, children, young people and parents access farm via farm drive and into visitor's car park. Staff access the farm through the second farm entrance into a staff car park.</p> <p>Visiting cars to drive under 15mph on farm drive. There are signs and CCTV to monitor this. Staff to address any drivers seen to not adhere to the speed limits, or not being considerate and courteous in the car park. Children and young people are often anxious and to ensure safety we ask that all users of the car park use the car park exercising caution and consideration at all times.</p> <p>Visiting school groups to bring appropriate adult child ratio.</p>	LOW

Walking on the Farm	Injury from slipping, tripping and falling; uneven cobbles and steps, wet ground	All	HIGH	<p>Children, young people and adults to wear suitable clothing and footwear. Farm pathways and yard regularly swept of debris. Due to the uneven nature of some of the ground surfaces, children should not run at the farm and should be supervised by staff/carers. Children are not to be unsupervised, and when young people, as part of their independence pathway are allowed to walk around farm areas unescorted, this is done with staff's overall supervision (ie planned, with full awareness of location and timings).</p> <p>Signs displayed to make all walkers aware of uneven ground, and staff to ensure all CYP and visitors are reminded of the irregular surfaces and the need for appropriate footwear and clothing at all times.</p>	MED
Farm Buildings/ Rooms	Workshops, feed room, cabin room, hay barns – injury from tools, or dangerous substances	All	MED	<p>All buildings are kept locked when not used in sessions and supervised by the staff running the session. Buildings to be tidied and all items to be cleared away after each use. Tools to be kept in locked away tools' storage, and all substances that may pose a risk such as chemicals to be kept in the COSHH cupboard inside the 1-1 Room</p> <p>Metal fencing closed and covering hazardous machinery</p> <p>'No entry' sign displayed and doors locked for every storage area on the farm.</p>	LOW
Using kitchen equipment and tools	Kitchen – scalding from hot water	All	LOW	<p>Individuals only to enter the kitchen with permission and young people in session to enter with staff only. Staff supervise all kitchen and cooking with the young people, including guiding the use of all appliances</p> <p>.</p>	LOW

Contact with Plants/ Fungi	Plant scratches, stings/ allergies. Poisoning from plants/ fungi.	All	MED	Pathways/yard to be kept clear of vegetation. All CYP/Visitors to be aware of potential risks, such as ragwort and Stinging nettles. Staff to be aware of the potential poisonous plants and alert management for the removal to be actioned.	LOW
Farm Equipment and Tools	Injury from improper use	All	MED	Tools stored securely when not in use. Individuals or groups only to use tools with permission and after instruction with staff as necessary. Tools kept well-maintained for safe usage. Children and young people are not to use any farm machinery (until appropriate training potentially in the future).	LOW
Other farm users	Safeguarding issues	All	MED	staff and regular volunteers at the farm are DBS checked, and operate within the Elysian's safeguarding policy . Farm staff are identified by staff badges (and Elysian polo shirts). During the young people's session times (9am-3.30PM), external visitors are escorted at all times.	LOW
Flooding	Access to main farm may be flooded, preventing cars / taxis from accessing the driveway.	All	MED	First staff on site to inform SLT about flooded driveway. Staff to ensure that high vis vests are worn and at least 4 staff are standing out on main entrance area to support taxi drop of / collection of YPs, blocking road to oncoming traffic if needed. Site vehicle to transport YPs safely up the driveway through flooded area to get to main stable building, safely. Staff to monitor flood levels throughout the day.	LOW

Mud / slippery surfaces	Injury from slipping in mud, falling in a paddock with animals around, slipping while handling large animals	All	MED	When areas are extremely muddy / slippery, only experienced staff to move horses through muddy areas. YPs to be reminded by staff to make sure appropriate footwear is being worn in muddy / slippery areas. All staff and YPs to move slowly and carefully in muddy/slippery areas.	LOW
Fire	Burns, smoke inhalation, trampling	All	LOW	Please see the Fire Risk assessment and policy for Elysian. In the event of fire leave the farm following instructions from farm staff. Meeting points signposted to The Orchard	LOW

Risk Assessor: Charlotte Williams

Latest Review Date: 17/02/2023, **Updated** 08/04/24 JM, **Updated** 19/09/24 JM, **Updated** 22/05/25 JM